

Electrical Specification:  
Contact Resistance: 5V 10mA  
Insulation Resistance: DC100V/1min  
Dielectric voltage proof: 250VAC(50Hz/60Hz)/1min  
Mechanical Specification:  
Operating Force:250±50gf  
Full Travel:0.3±0.1mm  
Return Force:50gf min  
Stem Strength:20N.min  
Solderability:  
(1)Solder temperature:245±5℃  
(2)Immersion time:2s±0.5s

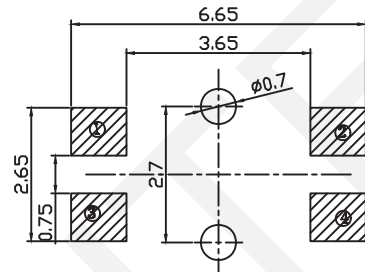
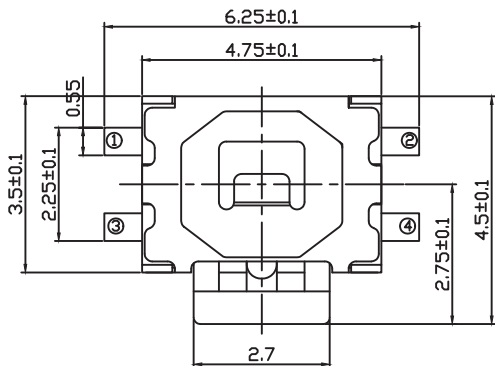

#### ORDER INFORMATION

RHTGYS6617-1.65-250-T

SMD Tactile Switches

Height:1.65mm

Operating Force:180±50gf,250±50gf

Ti:Tape Packing

Serial number	Name	Material Science	Number	Remarks
G	Outer dust-proof	0.05	1	
F	Cover plate	Stainless steel 0.15	1	pickling
E	Button	PA46	1	
D	Dustproof film	0.05	1	
C	Reed	Stainless steel clad Silver	1	
B	Base	LCP Black	1	
A	Card	Copper 0.15	1	Plate w ith silver