

# ELECTRICAL

- 1.Rating:50mA 12V DC
- 2.Contact Resistance :50mΩ Max(Initial)
- 3.Insulation Resistance:100MΩ(Min DC 250V)
- 4.Dielectric Strength:AC 250V(50/60Hz For 1minute)
- 5.Electrically Life:100000 Cycles
- 6.Environment Temperature:-20°C~+70°C
- 7.Operating Force:180/250(±30gf)
- 8.Seal Temperature:260°C~280°C

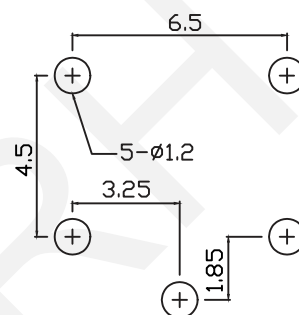
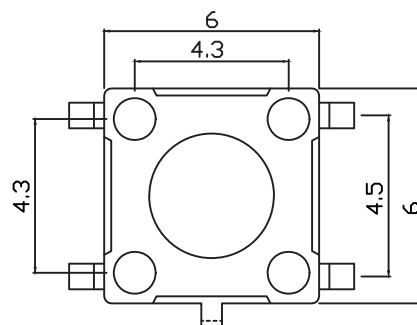

PCB LAYOUT

# ORDER INFORMATION

RHTGYS6602-4.3-180

Series No:

Height:4.3mm/5.0mm/6.0mm/7.0mm/8.0mm

Operating Force :180~250gf

H
4.3
5.0
6.0
7.0
8.0

**RHTECP** NINGBO RHT ELECTRONIC CO.,LTD

UNITS:mm	SHEET SIZE: A4	SCALE:---	DRWN BY PAN
0~3	3~18	18~50	50~120
±0.12	±0.15	±0.3	±0.5

CHK'D BY FENG

APPR BY ZHAN

6x6 Tact Switch Series

THIRD ANGLE PROJECTION



RHTGYS6602