

P/N: RE-C-SMA020

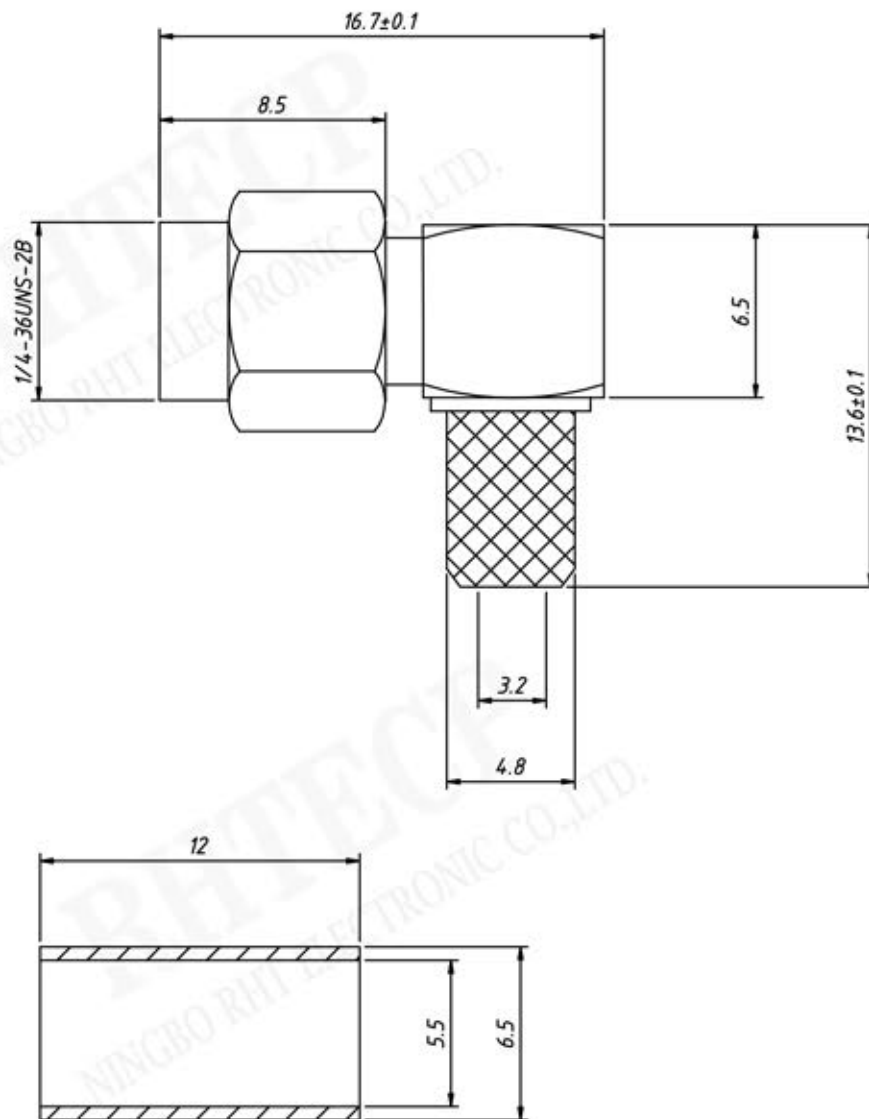

Electrical Specifications:

Impedance: 50Ω

Frequency Range Semi-rigid cable: 0-18 GHz

Flexible cables: 0-12.4 GHz

Voltage Rating : 335 volts rms.

Dielectric Withstanding Voltage : 500 volts rms.

VSWR : $1.15 + 0.02 f$ (GHz) for Straight connector typical

$1.25 + 0.025 f$ (GHz) for Right angle connector typical

Contact Resistance Center contact: $2.0 m\Omega$

Body: $2.0 m\Omega$

Insulation Resistance: $5,000 M\Omega$

Mechanical Specifications:

Mating: $1/4"-36$ UNS thread coupling

Cable retention: 6kgf typical

Durability: 500 Cycles Min.

Coupling nut retention: 18kgf Min.

Temperature Range: -55°C to $+155^\circ\text{C}$

Material:

Connector body: Brass per QQ-B-626 ,gold Plating or nickel

Center contact Male: Brass, gold Plating

Center contact Female: Beryllium copper, gold Plating

Insulator: PTFE

Gasket: Silicone rubber

Crimp Ferrule: Annealed copper