

PCB LAYOUT

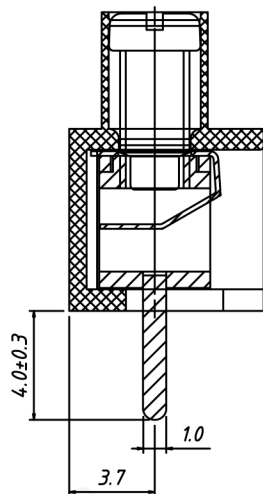

SECTION A-A



Material

Screw: M3, Steel, Zn plated
 Shrapnel: Stainless steel, Nickel plated
 Pin header: Brass, Tin plated
 Housing: PA66, UL94V-0

Electrical

Rated voltage: 300V
 Rated current: 15A
 Wire range: 26~14AWG 2.5mm²
 Contact Resistance: 20 mΩ
 Insulation resistance: 500MΩ/DC500V
 Withstand voltage: AC2000V / 1 min

Mechanical

Temp. Range: -40 °C ~ +105 °C
 Soldering: 250°C ±5°C for 5S
 Torque: 0.5 N.m (4.43Lb. in)
 Strip length: 6~7 mm

Order Information

RE - C - 166 - 5.00 - XXP - 4 S XX

RoHS
 Terminal Block
 Pitch
 No. of Pole

Product Code: 00~99
 Screw: S- Slot Screw
 C- Cross Screw
 Color: 4-Green

UNITS: mm		SHEET SIZE: A4		SCALE: ---	
> 0 ~ 3	> 3 ~ 18	> 18 ~ 50	> 50 ~ 120		
± 0.12	± 0.15	± 0.3	± 0.5		