

PCB LAYOUT

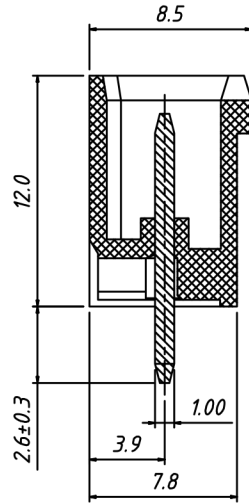

SECTION A-A

*Material*

Pin header: Brass , Tin plated

Housing: LCP , UL 94V-0,Black

*Electrical*

Rated voltage: 300V

Rated current: 15A

Contact Resistance: 20 mΩ

Insulation resistance: 500MΩ/DC500V

Withstand voltage: AC2000V / 1 min

*Mechanical*

Temp. Range: -40 °C ~ +130 °C

Soldering: 285° C±5° C for 10S

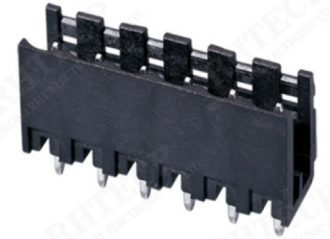

*Order Information*

RE - C - THREDV - 5.08-XXP-S XX

RoHS

Terminal Block

Pitch

No.: of Pole

Product Code:00~99

Screw: S- Slot Screw

C- Cross Screw



NINGBO RHT ELECTRONIC CO.,LTD

UNITS:mm

SHEET SIZE:A4

SCALE: ---

> 0 ~ 3

> 3 ~ 18

> 18 ~ 50

> 50 ~ 120

± 0.12

± 0.15

± 0.3

± 0.5

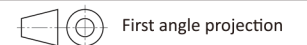

TERMINAL BLOCK